

OVERALL DIMENSIONS

DROP-IN COOK TOPS

SIZE	'A'	*'B'	'C'	'D'	'E'
30 IN.	24"	33"	10"	3 1/4"	8 1/2"
36 IN.	30"	39"	16"	2"	15"
40 IN.	36"	45"	10"	3 1/4"	8 1/2"

*DIM 'B': RECOMMENDED CABINET WIDTH

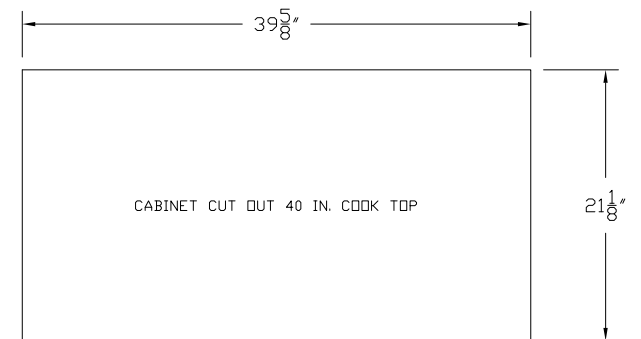
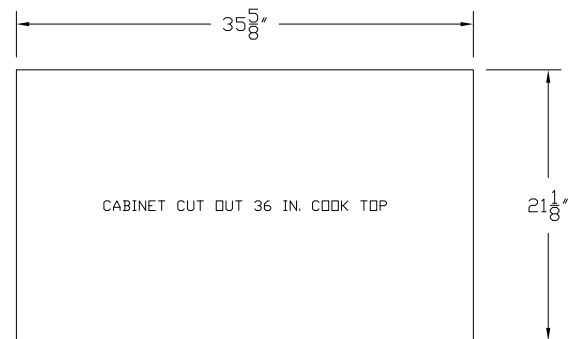
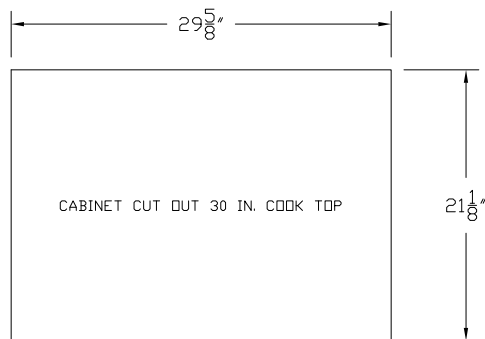
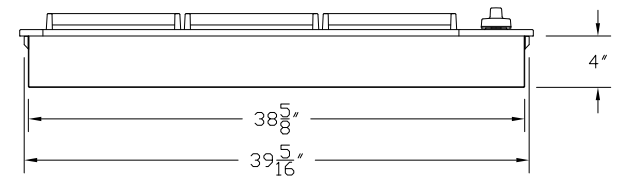
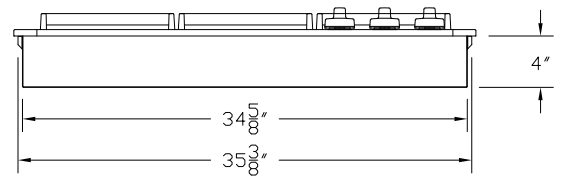
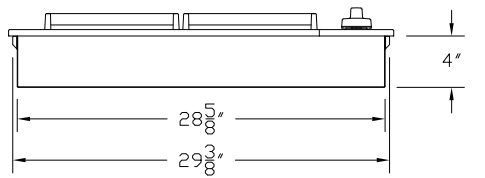
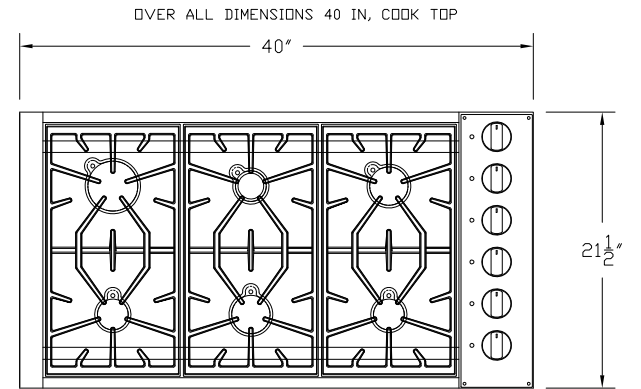
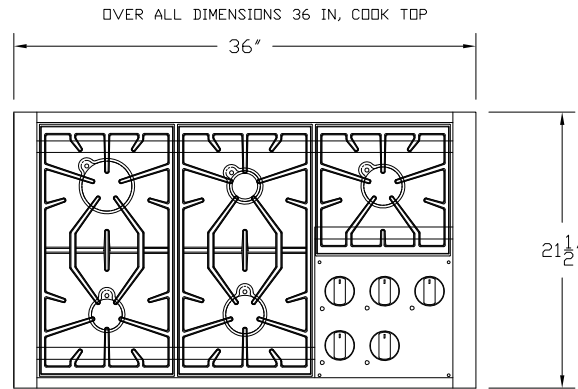
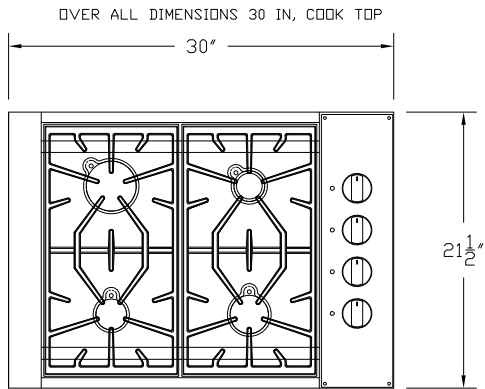

INSTALLATION SPECIFICATIONS

DROP-IN COOK TOPS

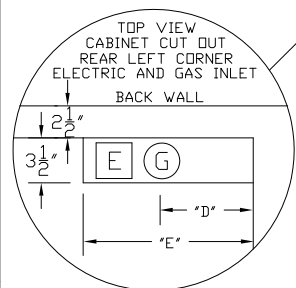
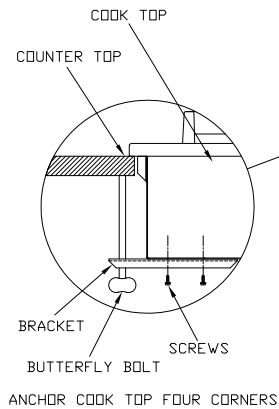
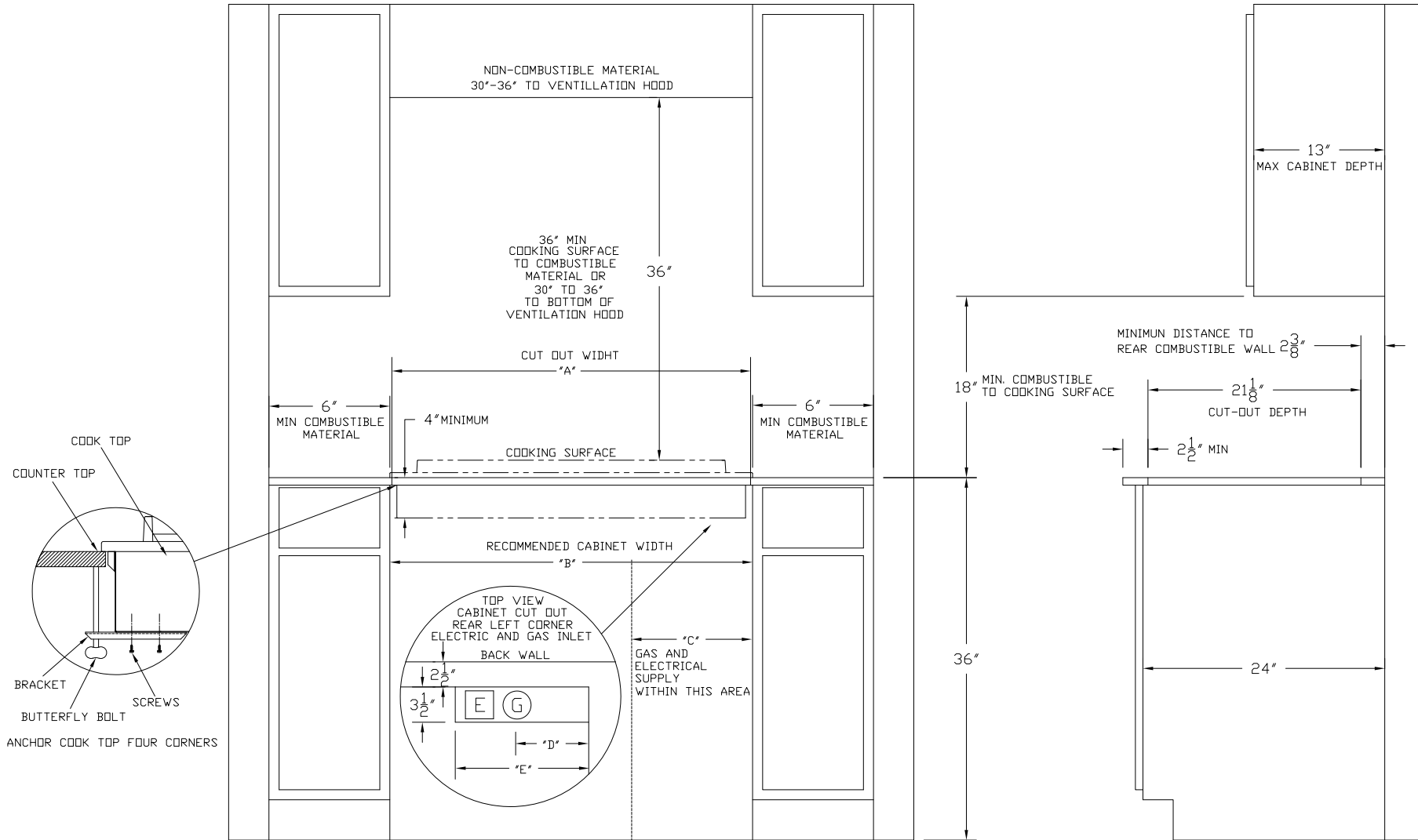

G E LOCATION OF GAS AND ELECTRICAL SUPPLY

- ELECTRIC OUTLET - STANDARD 3 PRONG 120 V
- ALLOW FOR A SHUT OFF VALVE AT GAS OUTLET
- ISLAND OR PENINSULA INSTALLATIONS REQUIRES A 10" MINIMUM CLEARANCE FROM BACK OF RANGE TO A COMBUSTIBLE SURFACE
- ISLAND TRIM 0 IN. CLEARANCE TO NON COMBUSTIBLE SURFACE
- NO SIDE WALL ABOVE COOKING SURFACE
- ALLOW FOR A SHUT OFF VALVE AT GAS OUTLET
- SECURE THE COOKTOP ON EACH CORNER TO THE COUNTER WITH (4) ANCHORING BRACKETS PROVIDED